



40, Bukova str.
Kharkiv 61051, Ukraine

+44 7700 181 553
e-mail: info@inegva.eu
www.inegva.eu

INSTALL

MOUNT CABLE TIE

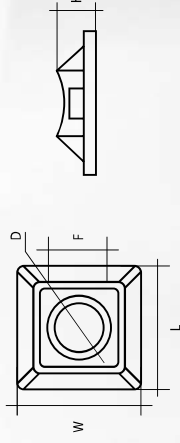

DESIGNED FOR INSTALLATION OF CABLE TIES ON DIFFERENT SURFACES USING SCREWS AND SELF-TAPPING SCREWS



ARTICLE	NAME OF PRODUCT	L, MM	W, MM	Hole Ø, MM	ULTIMATE TENSILE STRENGTH, KG	QUANTITY PER PACKAGE, PCS.	PACKAGES PER CARTON BOX, PCS.	QUANTITY IN 1 CARTON BOX, PCS.	CARTON BOX WEIGHT, KG	CARTON BOX TYPE
CTP20X20	20X20 (self-adhesive)	20	20	5	22	50	100	5000	5,8	A
CTP20X20	20X20 (with screw hole)	20	20	5	22	50	100	5000	5,4	A

MATERIAL: Nylon 6.6

RESISTANCE: solvents, greases and oils

COLOR: white, black

WORKING TEMPERATURE: -45°C - 80°C

FIRE-RESISTANCE MATERIAL: according to UL94V2 - self-extinguishing

COLOR PALLETTE



Standard colors: natural, black. The colors indicated in the palette are available for production. The minimum quantity for production in non-standard palette can be negotiated individually. The products correspond with the EN 62275:2015, EN50581:2012 standards and the requirements of : Voltage Directive 2014/35/EU, RoHS Directive 2011/65/EU.

